

State of South Carolina  
 Pursuant to a warrant from John Thomas Esq. Commissioner of Locations dated the 21<sup>st</sup> May 1784 I have Admeasured and Laid out unto William Giles, a tract of Land containing Six hundred & forty acres situated in Ninety six District, west of the Indian Boundary, onuddy River, of Saluda, about two miles above Richard Paris's plantation bounding on all sides by vacant Land. Shalk such from 9 marks as the above plat represents, surveyed the 26<sup>th</sup> May 1784 - George Salmon Surveyor

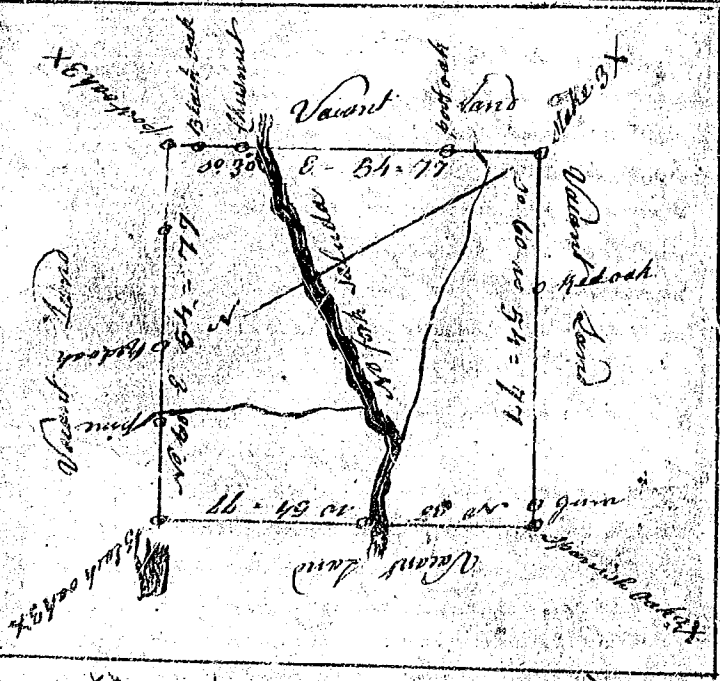

State of South Carolina  
 Pursuant to a Warrant from John Thomas Esq. Commissioner of Locations dated the 24<sup>th</sup> day of May 1784 I have Admeasured and Laid out unto William Goodlett a tract of Land in the district of Ninety six, containing Three hundred acres, bounding on all sides by vacant Land, and hath such Shape form and Marks as the above plat represents, -  
 Surveyed the 25<sup>th</sup> day May 1784  
 Del. this Survey Region 23<sup>rd</sup> day, Laid out and Closed the line between Eight & nine o'clock morning  
 Del. to Wm. Giles 1784, J. Wm. Brown Esq.

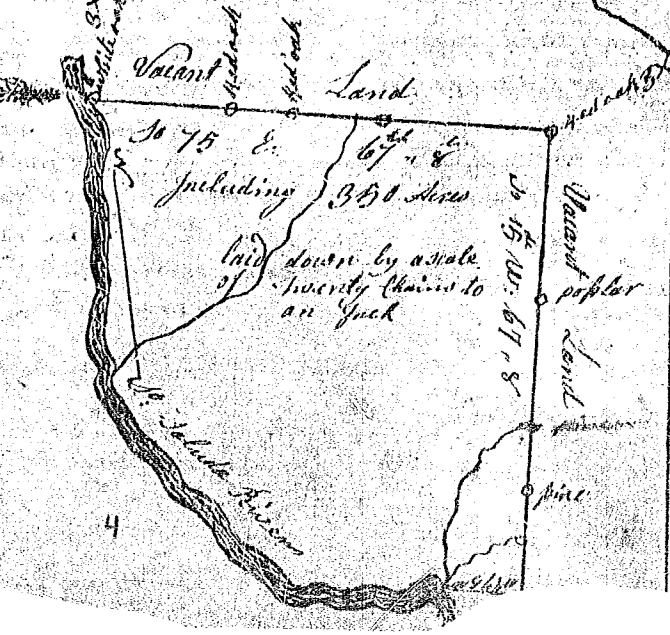

State of South Carolina  
 Pursuant to a warrant from John Thomas Esq. Commissioner of Locations dated the 21<sup>st</sup> day of May 1784 I have Admeasured and Laid out unto William Smith a tract of Land in the district of Ninety six north side Saluda containing Three hundred and fifty acres, bounding on the west by Saluda River on all other sides by Vacant Land, and hath such Shape form & Marks as the above plat represents. Surveyed the 23 day of May 1784  
 Del. to Wm. Brown Esq.  
 Del. to Wm. Smith